

PN 16 / CLASS 125 / JIS 10K

Flange Type Swing Check Valve • Bronze Trim

Fig. 5101 (Class 125 & PN16)  
5102 (Class 250 & PN25)



**Valve Standard :**

Comply with EN 12334(BS 5153) & MSS SP-71  
Bronze / Resilient seat , Epoxy coated , flanged to ANSI  
Class125, BS4504 PN 16, JIS 10K

**Pressure Temperature Ratings**

Working pressure	16bar/125Lb/250Lb
Testing Pressure	Shell:24bar/51.7 Seat:17.6bar/34.5
Working Temperature	-10°C to 120°C
Suitable Media	Water,Oil&Gas

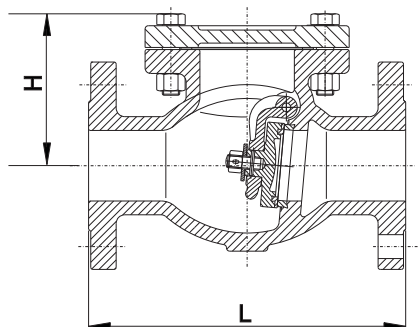

**Material Specification**

Part	Material	ASTM Spec.	BS
Body	Cast Iron	A126 Class B	1452 Gr.220
	Ductile Iron	A536 65-45-12	1563 EN-JS1040
Cover	Cast Iron	A126 Class B	1452 Gr.220
	Ductile Iron	A536 65-45-12	1563 EN-JS1040
	Cast Iron	A126 Class B	1452 Gr.220
Disc	Ductile Iron	A536 65-45-12	1563 EN-JS1040
	Bronze	B62 C83600	1400 LG2
	SS304	A351 CF-8	970 304S15
	SS316	A351 CF-8M	970 316S16
Seat Ring	Bronze	B62 C83600	1400 LG2
Disc Ring	Bronze	B62 C83600	1400 LG2
Gasket	Non Asbestos		

**Dimensions**

DN	mm	50	65	80	100	125	150	200	250	300	350	400	450	500	600
	inch	2	2-1/2	3	4	5	6	8	10	12	14	16	18	20	24
	L	203	216	241	292	330	356	495	622	699	787	914	914	1016	1219
	H	112	132	141	162	192	211	270	316	357	560	589	645	702	812